

FF

Angle extra large

CARACTERISTIQUES

- Fabrication monobloc
- Peu sujet aux bouchages
- Peu d'usure
- Toutes les buses 3/8" en laiton sont approuvées "UL"
- Raccordement mâle

PARAMETRES DU JET

- Angle extra large 145°
- Jet à impact moyen
- Angle d'impact dévié à 75°
- **Forme du jet:** Jet plat
- **Angles du jet:** 105° et 145°
- **Débits:** de 0,510 à 757 l/min



Plastique



Jet plat 145°

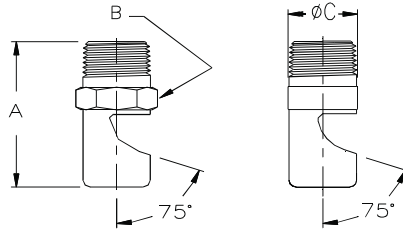

Métal

Matière plastique

Les dimensions sont approximatives - Contactez BETE pour toute application spécifique

FF Jet plat - Débits

Angles disponibles: 105° et 145° - Raccords 1/8" à 1" BSP ou NPT

| Racc mâle | Réf. buse | Angles | Coef. K | Débit en litre par minute | | | | | | | | Diamètre orifice (mm) |
|------------------|--------------|--------|------------|---------------------------|------------|------------|----------|----------|----------|----------|-----------|-----------------------------|
| | | | | 0,2 bar | 0,5 bar | 0,7 bar | 1 bar | 2 bar | 3 bar | 5 bar | 10 bar | |
| 1/8 | FF016 | 105° | 0.114 | 0.0510 | 0.0806 | 0.0953 | 0.114 | 0.161 | 0.197 | 0.255 | 0.360 | 0.406 |
| | FF024 | 105° | 0.228 | 0.102 | 0.161 | 0.191 | 0.228 | 0.322 | 0.395 | 0.510 | 0.721 | 0.610 |
| | FF028 | 105° | 0.342 | 0.153 | 0.242 | 0.286 | 0.342 | 0.483 | 0.592 | 0.764 | 1.08 | 0.711 |
| | FF033 | 105° | 0.456 | 0.204 | 0.322 | 0.381 | 0.456 | 0.645 | 0.789 | 1.02 | 1.44 | 0.838 |
| | FF041 | 145° | 0.684 | 0.306 | 0.483 | 0.572 | 0.684 | 0.967 | 1.18 | 1.53 | 2.16 | 1.04 |
| | FF046 | 145° | 0.912 | 0.408 | 0.645 | 0.763 | 0.912 | 1.29 | 1.58 | 2.04 | 2.88 | 1.17 |
| | FF052 | 145° | 1.14 | 0.510 | 0.806 | 0.953 | 1.14 | 1.61 | 1.97 | 2.55 | 3.60 | 1.32 |
| | FF057 | 145° | 1.37 | 0.611 | 0.967 | 1.14 | 1.37 | 1.93 | 2.37 | 3.06 | 4.32 | 1.45 |
| FF065 | 145° | 1.82 | 0.815 | 1.29 | 1.53 | 1.82 | 2.58 | 3.16 | 4.08 | 5.77 | 1.65 | |
| 1/8 or 1/4 | FF073 | 145° | 2.28 | 1.02 | 1.61 | 1.91 | 2.28 | 3.22 | 3.95 | 5.10 | 7.21 | 1.85 |
| | FF093 | 145° | 3.42 | 1.53 | 2.42 | 2.86 | 3.42 | 4.83 | 5.92 | 7.64 | 10.8 | 2.36 |
| | FF104 | 145° | 4.56 | 2.04 | 3.22 | 3.81 | 4.56 | 6.45 | 7.89 | 10.2 | 14.4 | 2.64 |
| | FF116 | 145° | 5.47 | 2.45 | 3.87 | 4.58 | 5.47 | 7.73 | 9.47 | 12.2 | 17.3 | 2.95 |
| 1/4 | FF125 | 145° | 5.70 | 2.55 | 4.03 | 4.77 | 5.70 | 8.06 | 9.87 | 12.7 | 18.0 | 3.18 |
| | FF129 | 145° | 6.84 | 3.06 | 4.83 | 5.72 | 6.84 | 9.67 | 11.8 | 15.3 | 21.6 | 3.28 |
| | FF141 | 145° | 8.20 | 3.67 | 5.80 | 6.86 | 8.20 | 11.6 | 14.2 | 18.3 | 25.9 | 3.58 |
| | FF148 | 145° | 9.12 | 4.08 | 6.45 | 7.63 | 9.12 | 12.9 | 15.8 | 20.4 | 28.8 | 3.76 |
| 1/4 | FF156 | 145° | 10.0 | 4.48 | 7.09 | 8.39 | 10.0 | 14.2 | 17.4 | 22.4 | 31.7 | 3.96 |
| | FF161 | 145° | 10.9 | 4.89 | 7.73 | 9.15 | 10.9 | 15.5 | 18.9 | 24.5 | 34.6 | 4.09 |
| | FF173 | 145° | 12.3 | 5.50 | 8.70 | 10.3 | 12.3 | 17.4 | 21.3 | 27.5 | 38.9 | 4.39 |

$$\text{Débit (l/min)} = K \sqrt{\text{bar}}$$

FF - Dimensions

| Taille | Dim. (mm) | | | Poids (g) | |
|--------|-----------|------|------|-----------|-----|
| | A | B | C | M | P |
| 1/8 | 25.4 | 11.2 | 12.7 | 14 | 3 |
| 1/4 | 35.1 | 14.2 | 16.0 | 35 | 7.5 |

Matériaux standards: Laiton, aciers inoxydables 303 ou 316, PVC et PTFE

(PTFE et PVC pas valables pour les buses FF016 à FF028; PTFE pas valable pour les buses FF033 à FF065).

L'angle du jet varie avec la pression. Contactez nous en cas de demande particulière.

TO ORDER: specify pipe size, connection type, nozzle number, spray angle, and material.



Toutes les buses FF en 3/8" et en laiton, sont approuvées UL

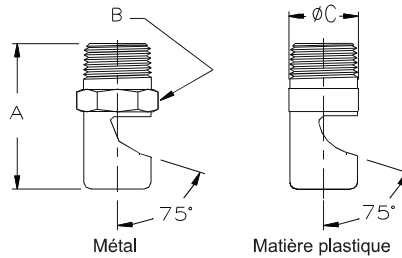

FAN

Les dimensions sont approximatives - Contactez BETE pour toute application spécifique

FF Jet plat - Débits

Angles disponibles: 105° et 145° - Raccords 1/8" à 1" BSP ou NPT

FF - Dimensions

| Racc mâle | Réf. buse | Angles | Coef. K | Débit en litre par minute | | | | | | | | Diamètre orifice (mm) | FF - Dimensions | | | | | |
|-----------|-----------|--------|---------|---------------------------|---------|---------|-------|-------|-------|-------|--------|-----------------------|-----------------|-----------|------|------|-----------|-----|
| | | | | 0,2 bar | 0,5 bar | 0,7 bar | 1 bar | 2 bar | 3 bar | 5 bar | 10 bar | | Taille | Dim. (mm) | | | Poids (g) | |
| | | | | | | | | | | | | | A | B | C | M | P | |
| 3/8 | FF187 | 145° | 13.7 | 6.11 | 9.67 | 11.4 | 13.7 | 19.3 | 23.7 | 30.6 | 43.2 | 4.75 | 3/8 | 44.5 | 17.5 | 19.1 | 72 | 15 |
| | FF196 | 145° | 16.0 | 7.1 | 11.3 | 13.3 | 16.0 | 22.6 | 27.6 | 35.7 | 50.4 | 4.98 | | | | | | |
| | FF209 | 145° | 17.0 | 7.6 | 12.0 | 14.2 | 17.0 | 24.0 | 29.4 | 38.0 | 53.8 | 5.31 | | | | | | |
| | FF218 | 145° | 18.2 | 8.2 | 12.9 | 15.3 | 18.2 | 25.8 | 31.6 | 40.8 | 57.7 | 5.54 | | | | | | |
| | FF221 | 145° | 20.5 | 9.2 | 14.5 | 17.2 | 20.5 | 29.0 | 35.5 | 45.9 | 64.9 | 5.61 | | | | | | |
| 1/2 | FF209 | 145° | 17.0 | 7.6 | 12.0 | 14.2 | 17.0 | 24.0 | 29.4 | 38.0 | 53.8 | 5.31 | 1/2 | 50.8 | 22.4 | 22.4 | 117 | 25 |
| | FF218 | 145° | 18.2 | 8.2 | 12.9 | 15.3 | 18.2 | 25.8 | 31.6 | 40.8 | 57.7 | 5.54 | | | | | | |
| | FF250 | 145° | 23.9 | 10.7 | 16.9 | 20.0 | 23.9 | 33.8 | 41.4 | 53.5 | 75.7 | 6.35 | | | | | | |
| | FF256 | 145° | 27.3 | 12.2 | 19.3 | 22.9 | 27.3 | 38.7 | 47.4 | 61.1 | 86.5 | 6.55 | | | | | | |
| | FF281 | 145° | 31.9 | 14.3 | 22.6 | 26.7 | 31.9 | 45.1 | 55.3 | 71.3 | 101 | 7.14 | | | | | | |
| | FF312 | 145° | 36.5 | 16.3 | 25.8 | 30.5 | 36.5 | 51.6 | 63.2 | 81.5 | 115 | 7.92 | | | | | | |
| | FF375 | 145° | 54.7 | 24.5 | 38.7 | 45.8 | 54.7 | 77.3 | 94.7 | 122 | 173 | 9.53 | | | | | | |
| 3/4 | FF316 | 145° | 41.0 | 18.3 | 29.0 | 34.3 | 41.0 | 58.0 | 71.0 | 92 | 130 | 8.03 | 3/4 | 66.8 | 38.1 | 38.1 | 345 | 73 |
| | FF332 | 145° | 45.6 | 20.4 | 32.2 | 38.1 | 45.6 | 64.5 | 78.9 | 102 | 144 | 8.43 | | | | | | |
| | FF348 | 145° | 50.1 | 22.4 | 35.5 | 41.9 | 50.1 | 70.9 | 86.8 | 112 | 159 | 8.84 | | | | | | |
| | FF368 | 145° | 54.7 | 24.5 | 38.7 | 45.8 | 54.7 | 77.3 | 94.7 | 122 | 173 | 9.35 | | | | | | |
| | FF375 | 145° | 54.7 | 24.5 | 38.7 | 45.8 | 54.7 | 77.3 | 94.7 | 122 | 173 | 9.53 | | | | | | |
| | FF406 | 145° | 63.8 | 28.5 | 45.1 | 53.4 | 63.8 | 90.2 | 111 | 143 | 202 | 10.3 | | | | | | |
| | FF437 | 145° | 72.9 | 32.6 | 51.6 | 61.0 | 72.9 | 103 | 126 | 163 | 231 | 11.1 | | | | | | |
| | FF453 | 145° | 82.0 | 36.7 | 58.0 | 68.6 | 82.0 | 116 | 142 | 183 | 259 | 11.5 | | | | | | |
| | FF484 | 145° | 95.7 | 42.8 | 67.7 | 80.1 | 95.7 | 135 | 166 | 214 | 303 | 12.3 | | | | | | |
| | FF500 | 145° | 109 | 48.9 | 77.3 | 91.5 | 109 | 155 | 189 | 245 | 346 | 12.7 | | | | | | |
| 1 | FF578 | 145° | 137 | 61.1 | 96.7 | 114 | 137 | 193 | 237 | 306 | 432 | 14.7 | 1 | 85.9 | 50.8 | 50.8 | 908 | 192 |
| | FF625 | 145° | 166 | 74.4 | 118 | 139 | 166 | 235 | 288 | 372 | 526 | 15.9 | | | | | | |
| | FF703 | 145° | 205 | 91.7 | 145 | 172 | 205 | 290 | 355 | 459 | 649 | 17.9 | | | | | | |
| | FF750 | 145° | 239 | 107 | 169 | 200 | 239 | 338 | 414 | 535 | 757 | 19.1 | | | | | | |

$$\text{Débit (min)} = K \sqrt{\text{bar}}$$

Matériaux standards: Laiton, aciers inoxydables 303 ou 316, PVC et PTFE

L'angle du jet varie avec la pression. Contactez nous en cas de demande particulière.